

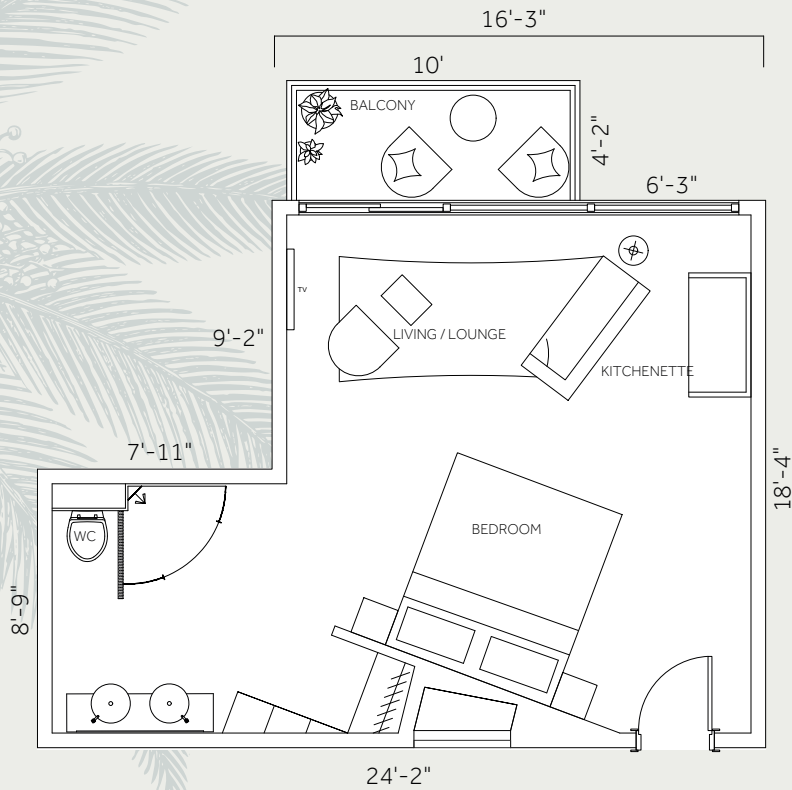

CAS EN BAS
Saint Lucia



STUDIO APARTMENT



AREA (SQ FT)

Lounge/ living & bedroom	326.36 Sq ft
Balcony	39.62 Sq ft
Total	365.98 Sq ft

AREA (SQ M)

Lounge/ living & bedroom	30.32 Sq m
Balcony	3.68 Sq m
Total	34.00 Sq m

This plan is for illustrative purposes only and should be used as such by any prospective purchaser. Whilst every attempt has been made to ensure the accuracy of the floor plans, measurements of doors, windows, rooms, and any other item are approximate, and no responsibility is taken by the developer for any unintentional error, omission, or misstatement. These images show items of furniture, fittings or other elements of specification that may not be included with the sale of property and do not form part of a sale contract, which are intended to give potential purchasers an indication of how the property might look when furnished. Whilst floor areas and dimensions are provided for guidance, the floor plans are produced to scale from the architect's plans to provide a general overview of the layout of the properties. June 2022



CAS EN BAS
Saint Lucia



ONE BEDROOM APARTMENT

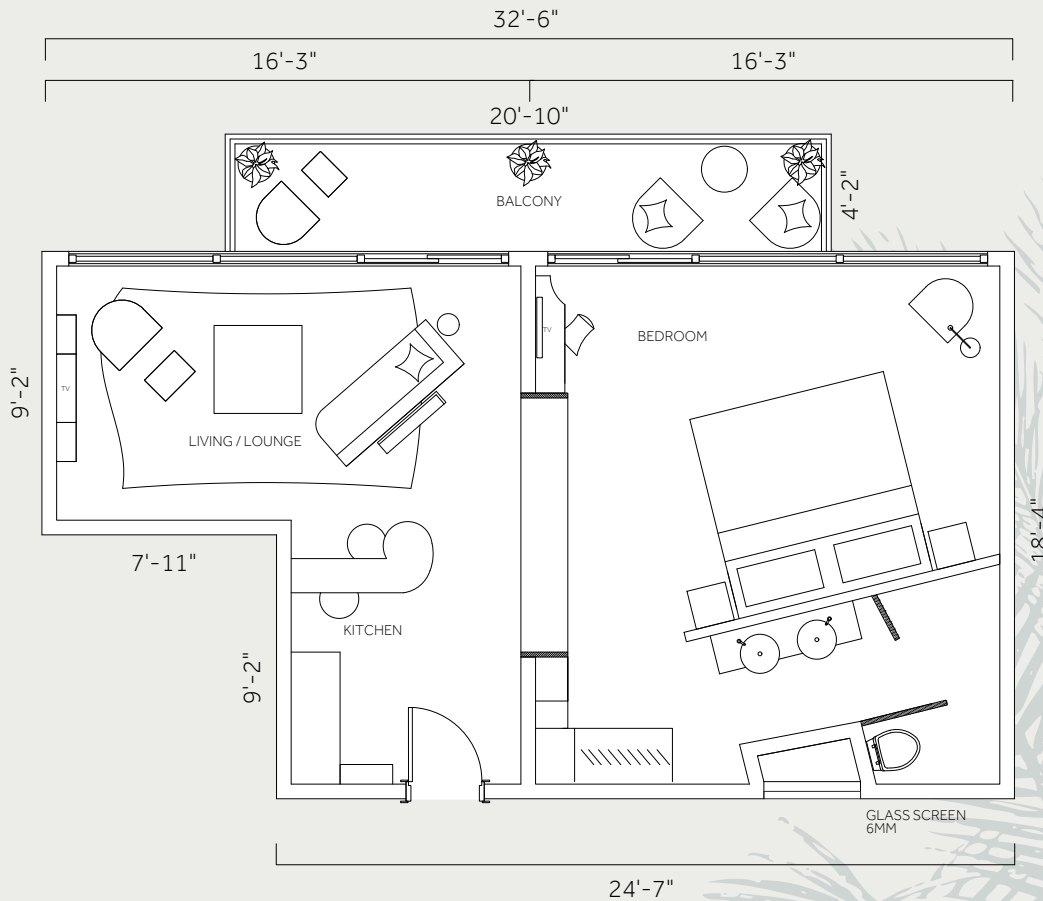

AREA (SQ FT)

Lounge/ living & Kitchen	201.29 Sq ft
Bedroom	263.61 Sq ft
Balcony	80.09 Sq ft
Total	544.99 Sq ft

AREA (SQ M)

Lounge/ living & Kitchen	18.70 Sq m
Bedroom	24.49 Sq m
Balcony	7.44 Sq m
Total	50.63 Sq m

This plan is for illustrative purposes only and should be used as such by any prospective purchaser. Whilst every attempt has been made to ensure the accuracy of the floor plans, measurements of doors, windows, rooms, and any other item are approximate, and no responsibility is taken by the developer for any unintentional error, omission, or misstatement. These images show items of furniture, fittings or other elements of specification that may not be included with the sale of property and do not form part of a sale contract, which are intended to give potential purchasers an indication of how the property might look when furnished. Whilst floor areas and dimensions are provided for guidance, the floor plans are produced to scale from the architect's plans to provide a general overview of the layout of the properties. June 2022

TWO BEDROOM APARTMENT

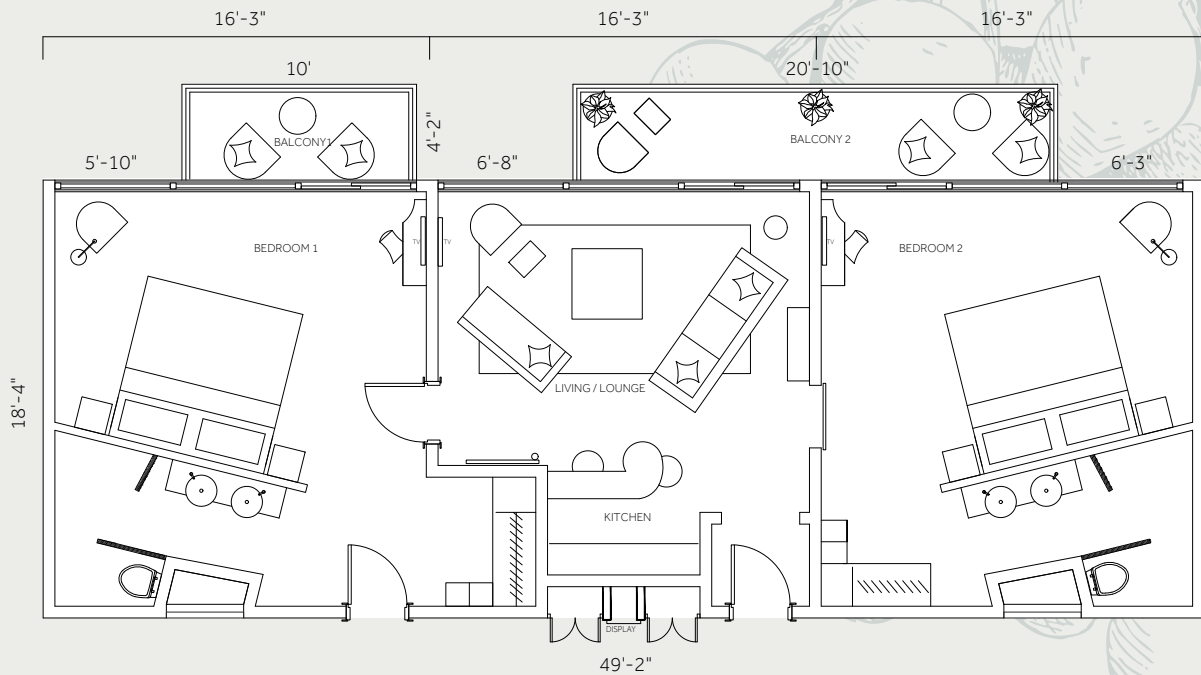

AREA (SQ FT)

Lounge/ living & Kitchen	233.15 Sq ft
Bedroom 1	288.47 Sq ft
Bedroom 2	263.72 Sq ft
Balcony 1	39.62 Sq ft
Balcony 2	80.09 Sq ft
Total	905.01 Sq ft

AREA (SQ M)

Lounge/ living & Kitchen	21.66 Sq m
Bedroom 1	26.80 Sq m
Bedroom 2	24.50 Sq m
Balcony 1	3.68 Sq m
Balcony 2	7.44 Sq m
Total	84.08 Sq m

SALES ENQUIRES:

info@casenbasbeachresort.com

UK: +44 (0)20 3442 0017

St Lucia: +1 758 721 8136

casenbasbeachresort.com

This plan is for illustrative purposes only and should be used as such by any prospective purchaser. Whilst every attempt has been made to ensure the accuracy of the floor plans, measurements of doors, windows, rooms, and any other item are approximate, and no responsibility is taken by the developer for any unintentional error, omission, or misstatement. These images show items of furniture, fittings or other elements of specification that may not be included with the sale of property and do not form part of a sale contract, which are intended to give potential purchasers an indication of how the property might look when furnished. Whilst floor areas and dimensions are provided for guidance, the floor plans are produced to scale from the architect's plans to provide a general overview of the layout of the properties. June 2022